

1968-70 8-CYL. ENGINE DELCOTRON MOUNTING

Key	Part Name	Group No.	Key	Part Name	Group No.
1	DELCOTRON & PULLEY ASM.,	2.275	6	PULLEY, C/Shaft-(7-1/4" dia.) Single.....	0.659
2	NUT, Delcotron Mounting Plate to Cyl. Head (3/8"-24).....	8.917	7	PLATE, C/Shaft Pulley Reinforcement.....	0.660
3	PLATE, Delcotron Mounting.....	2.277	8	BOLT, C/Shaft Pulley Reinforcement Plate to Pulley (5/16"-24 x 3/4")	2.275
4	SCREW, Delcotron to Plate-(5/16"-18 x 1-1/4").	8.977	9	BOLT, Delcotron to Plate & Cyl. Head (3/8"-16 x 6").....	2.275
5	SPACER, Delcotron to Plate & Cyl. Head (3-7/16" long).....	2.277			

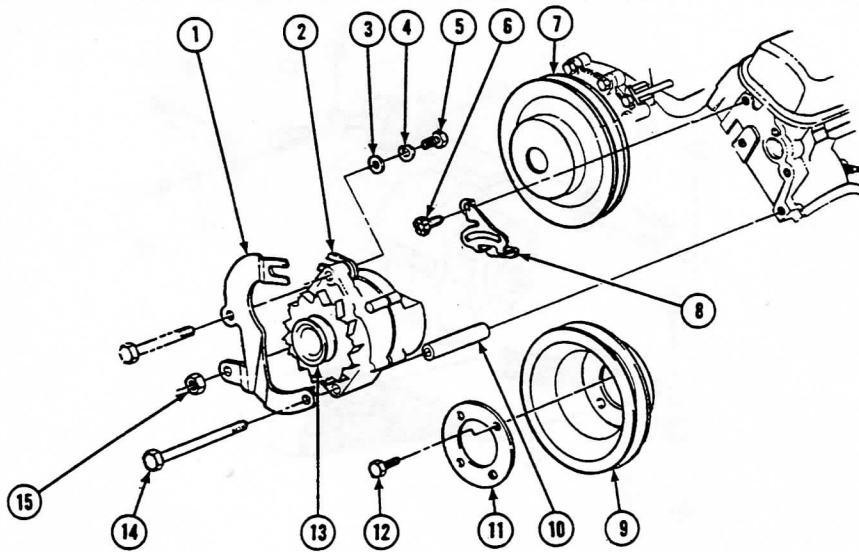

1971-72 8 CYL. ENGINE DELCOTRON MOUNTING

Key	Part Name	Group No.	Key	Part Name	Group No.
1	PLATE, Alternator Mounting.....	2.277	9	PULLEY, Shaft Harmonic	0.659
2	ALTERNATOR	2.275	10	SPACER, Plate to Cyl. Head (3 5/8" Long)	2.277
3	WASHER, Plate to Alt. (11/32" I.D. x 3/4" O.D.) ..	N.S.	11	PLATE, Shaft Pulley	0.660
4	LOCKWASHER, Plate to Alt. (5/16")	8.931	12	BOLT, Plate to Shaft Pulley (5/16"-24 x 3/4")...	8.900
5	BOLT, Plate to Alt. (5/16"-18	N.S.	13	PULLEY, Alternator	2.274
6	BOLT, Brace to Cyl. Head (3/8"-16 x 3/4")	8.900	14	BOLT, Plate to Alt. & Head (3/8"-16 x 6 5/16")	2.275
7	PULLEY, Water Pump & Fan	1.062	15	NUT, Plate attaching (3/8"-24)	8.917
8	BRACE, Alt. Rear	2.277			